

NaturePump NP50



Quiet running single-stage centrifugal pumps, complete with pre-filter.

Materials:

Pump body, pump foot and diffuser in glass loaded polypropylene.
 Impeller and seal mounting in PPO.
 Stainless steel motor shaft in AISI 420.
 Mechanical seal in graphite and ceramic,
 Aluminum L-2521 motor housing.

Motor:

Asynchronous, two poles.
 IP 55 protection.
 Class F insulation.
 Continuous operation.
 Single-phase version and built-in thermal protection.



Technical data

Model	HP	kW	V				A				P1 (kW)		Q	H(m)													
			1~		3~		1~		3~		1~			3~		L/min	0	50	100	150	200	250	300	350	400	450	500
			50HZ	50HZ	220V	380V	1~	3~	1~	3~	1~	3~		m3/h	0	3	6	9	12	15	18	21	24	27	30		
NP50-050	0.5	0.37	220	380	3.1	1.2	0.68	0.65	H(m)	15	14.5	13.3	11.5	9	6.5	3.5											
NP50-075	0.75	0.55	220	380	4.1	1.6	0.92	0.9		17.5	16.5	15	13	11	8	5											
NP50-100	1.0	0.75	220	380	5.2	1.8	1.15	1.1		18.2	17.8	17.2	16	14.5	12.2	9.5	6										
NP50-150	1.5	1.1	220	380	6.5	2.7	1.5	1.4		19.9	19.2	18.8	18	17	15.5	13.5	11.5	8									
NP50-200	2.0	1.5	220	380	9.4	3.7	2.1	2.0		20.4	20	19.6	19.2	18.3	17	15.2	13	10	7								
NP50-300	3.0	2.2	220	380	12.6	4.7	2.6	2.6		22.8	22.5	22.2	21.8	21.2	20	18.6	17	15	12.5	9							

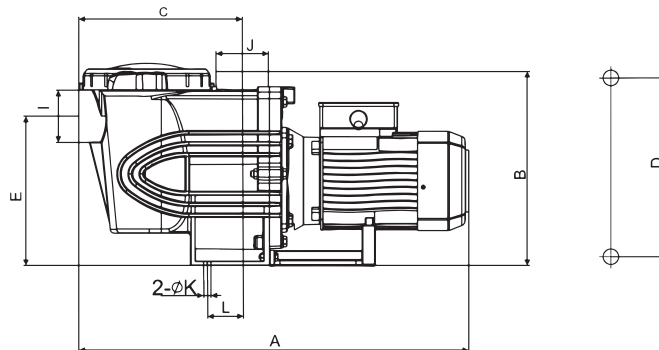
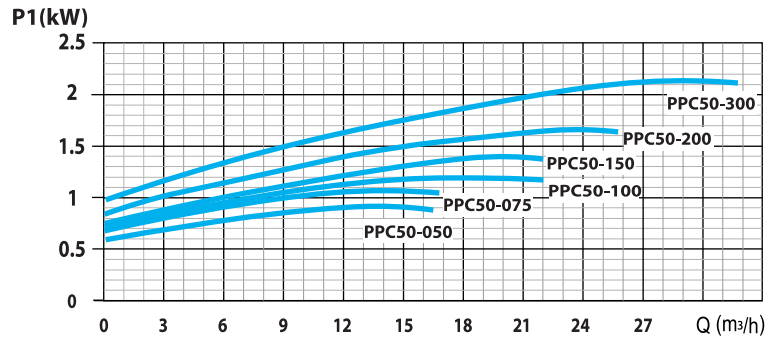
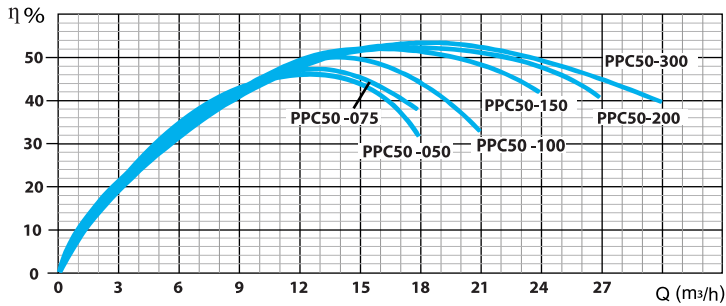
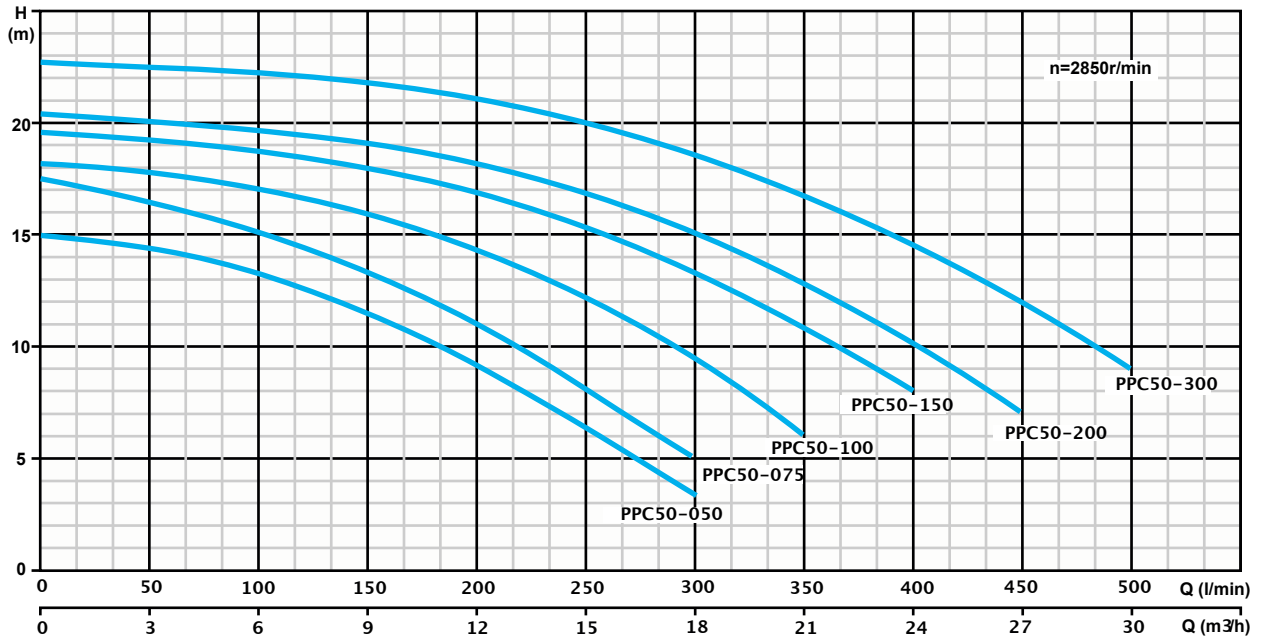

Dimensions									
Model	A	B	C	D	E	L	I	J	K
NP50-050	582	305	254	138.5	232	94	2"	2"	12
NP50-075	582	305	254	138.5	232	94	2"	2"	12
NP50-100	582	305	254	138.5	232	94	2"	2"	12
NP50-150	590	305	254	138.5	232	94	2"	2"	12
NP50-200	590	305	254	138.5	232	94	2"	2"	12
NP50-300	620	305	254	138.5	232	94	2"	2"	12

NaturePump NP60-150



Using the world's latests frequency conversion technology and a built-in digital display.

The pump is equipped with a permanent brush-less synchronous magnetic motor that is extremely efficient economy wise, which is also intelligent, quiet, and more reliable.

The characteristics of the product:

- High-performance equipped with permanent brush-less synchronous magnetic motor, quiet, and more efficient for a longer lifespan;
- The controller is equipped with a 2.4 inch LCD display and silicone keypads for convenient programming;
- Complete function, easy operation and clear menu;
- Power factor correction;
- Built-in diagnostic function such as, run-dry, overheating, voltage fluctuation, freezing and surge protection;
- Stunning design with better cooling and stable running.
- Uses current under 50/60hz with no drop in performance.

Working environment:

- Well ventilated for heat dissipation.
- Working environment temperature:-10C ~+40°C.

Technical data						
Model	HP	kW	Power Supply	Speed	RPM	MAX POWER CONSUMPTION
NP60-150	1.5	1.1	208-240v/50/60Hz	100%	3450	800-1700W
				80%	2760	500-900W
				50%	1725	150-300W

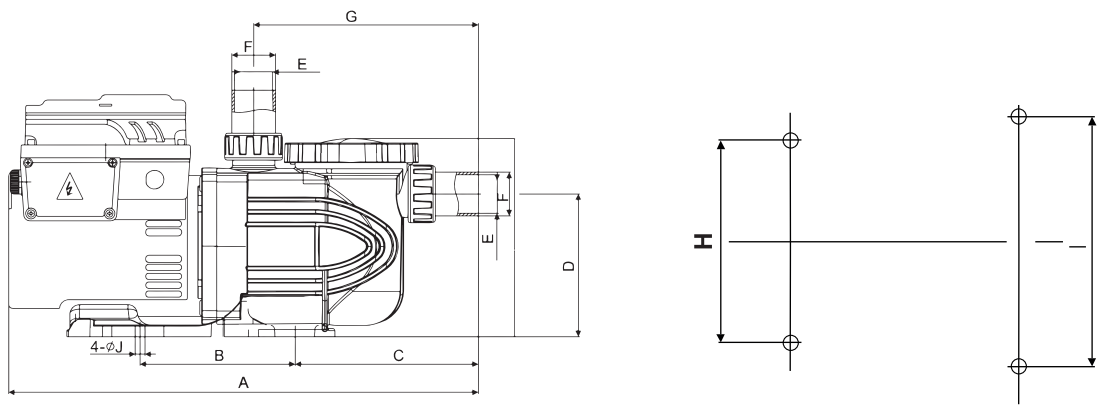
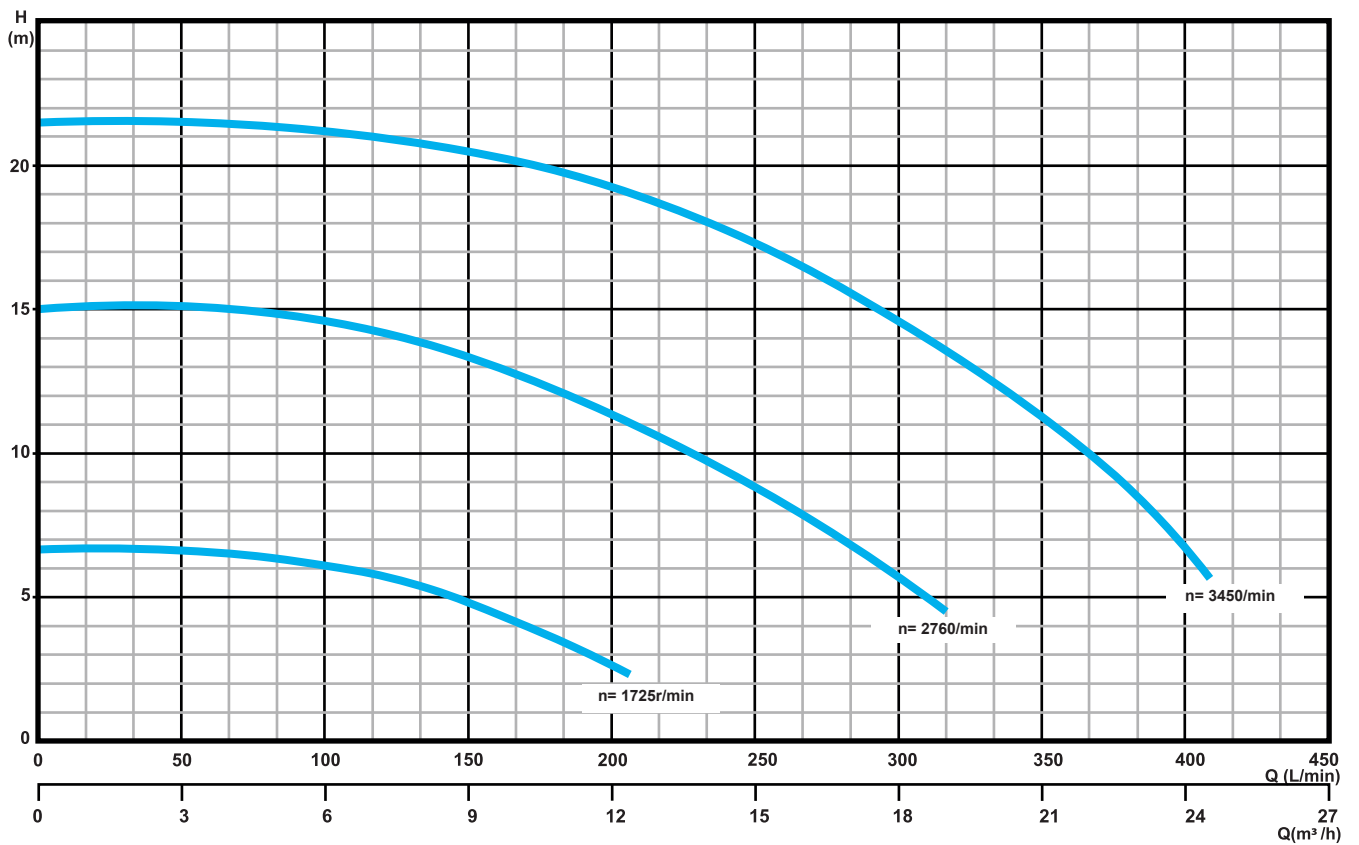

Dimensions

Model	A	B	C	D	E	F	G	H	I	J
NP60-150	635	134	296	195	Ø 50 (Ø 48)	Ø 60	305	154	190	11